

PLEASANT GROVE

<https://www.timberhavenloghomes.com>

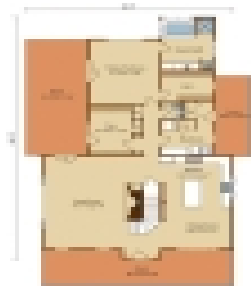

Pleasant Grove 2nd Floor

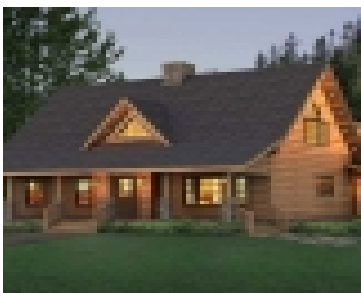
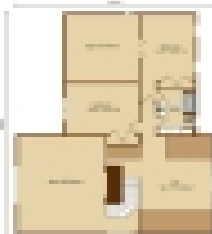

The Pleasant Grove log home design offers 3,187 square feet of total living space. The floor plan features 3 bedrooms and 2.5 baths. The log home plan provides spacious accommodations in virtually every room, from an incredible master bedroom suite to the open, combined kitchen and dining areas, stunning custom wall of glass and jaw-dropping [...]

- 3 beds
- 2 baths
- Log Home
- Farmhouse, Traditional
- 3187 sq ft

Plan Details

Date added: Added 2 years ago
Construction Type: Log Home
Bedrooms: 3 beds
Half baths: 1 half bath

Design Style: Farmhouse, Traditional
Area, sq ft: 3187 sq ft
Bathrooms: 2 baths



Related Plans

Related Plans: [es_my_listing layout="grid-3" posts_per_page="3" show_layouts="0" show_sort="0" show_page_title="0" show_total=0 prop_id="23427"]

Request More Information

Request More Information: [gravityform id="20" title="false"] [gravityform id="8" title="false"]

