

MEADOW VIEW II

<https://www.timberhavenloghomes.com>

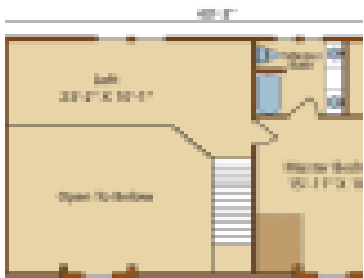
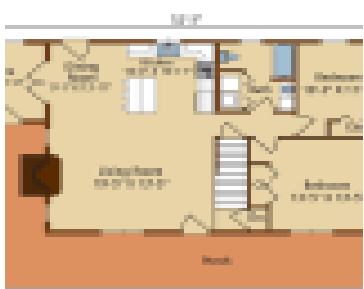

The Meadow View II log home design offers 1,992 square feet of total living space. The floor plan features 3 bedrooms and 2 baths. The log home plan provides an affordable design with front and rear dormers that create an eye-appealing exterior and a functional, roomy interior. Efficient space and a truly inviting atmosphere can [...]

- 3 beds
- 2 baths
- Log Home
- Cabin/Cottage, Farmhouse, Traditional
- 1992 sq ft

Plan Details

Date added: Added 2 years ago **Design Style:** Cabin/Cottage, Farmhouse, Traditional
Construction Type: Log Home **Area, sq ft:** 1992 sq ft
Bedrooms: 3 beds **Bathrooms:** 2 baths
Half baths: 0 half baths



Request More Information

Request More Information: [gravityform id="20" title="false"] [gravityform id="8" title="false"]

